

## CONVERTING A CLASSIC WELLHEAD SAMPLER TO ISOAMPLER™ GO

1.

Use two wrenches to split the Wellhead Sampler assembly above the gauge tee.

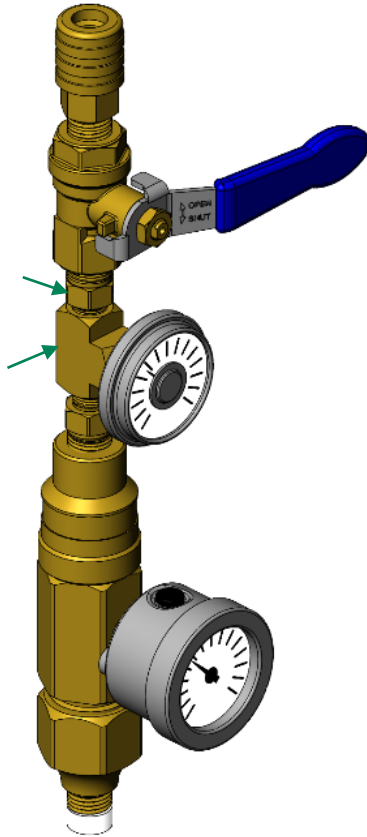

2.

Discard the upper valve assembly, and clean any Teflon tape remaining in the bottom fitting.

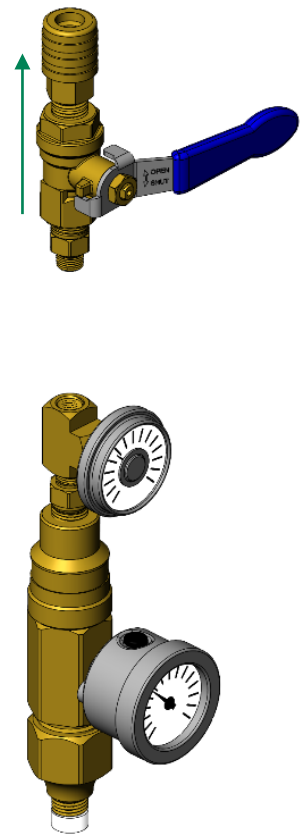

3.

The IsoSampler GO chuck should already have Teflon tape applied to the threads. Note that a 1/8" to 1/4" NPT reducing bushing has been included for older Wellhead Samplers equipped with 1/4" NPT tees.

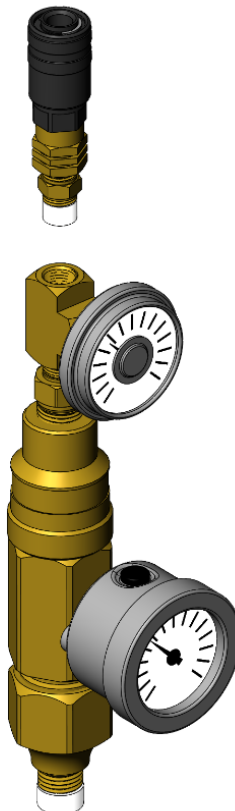

4.

Install the chuck and the reducing bushing (if necessary). Use two wrenches to tighten the fittings.

